

2 Product Facts

2.1 Product view

Console



Console's interface section

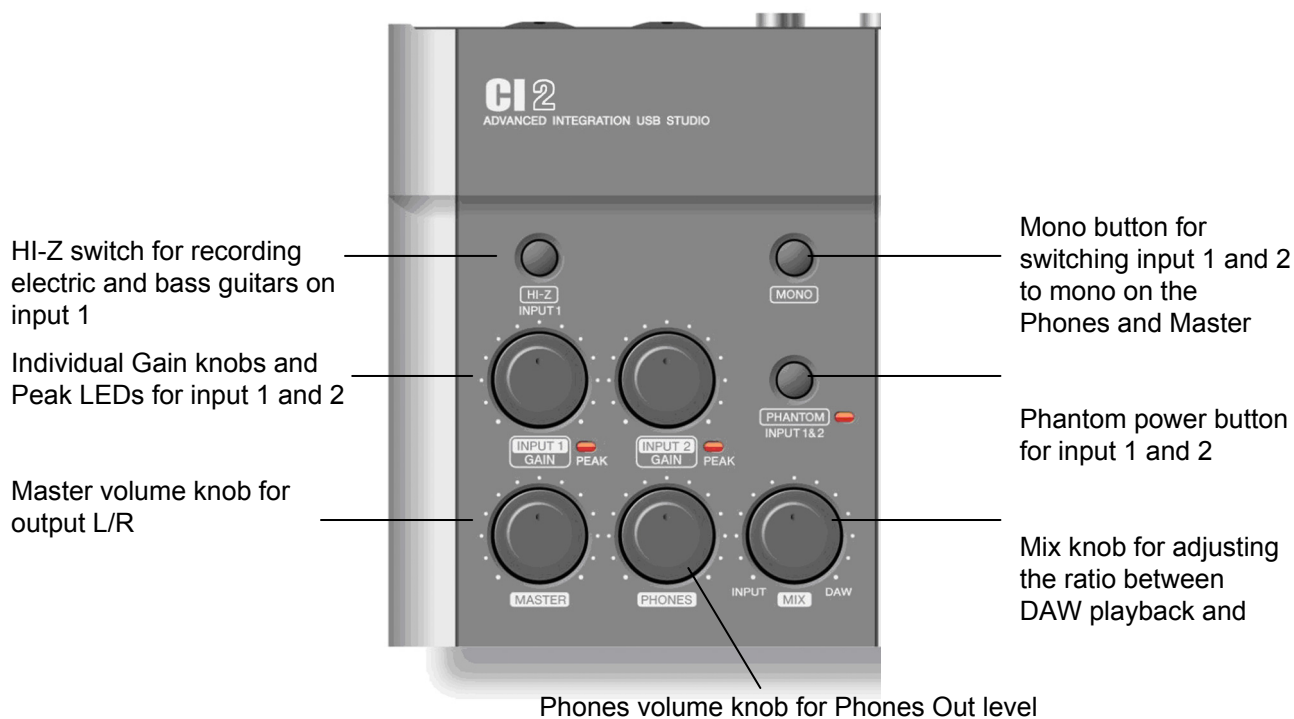

Console's controller section

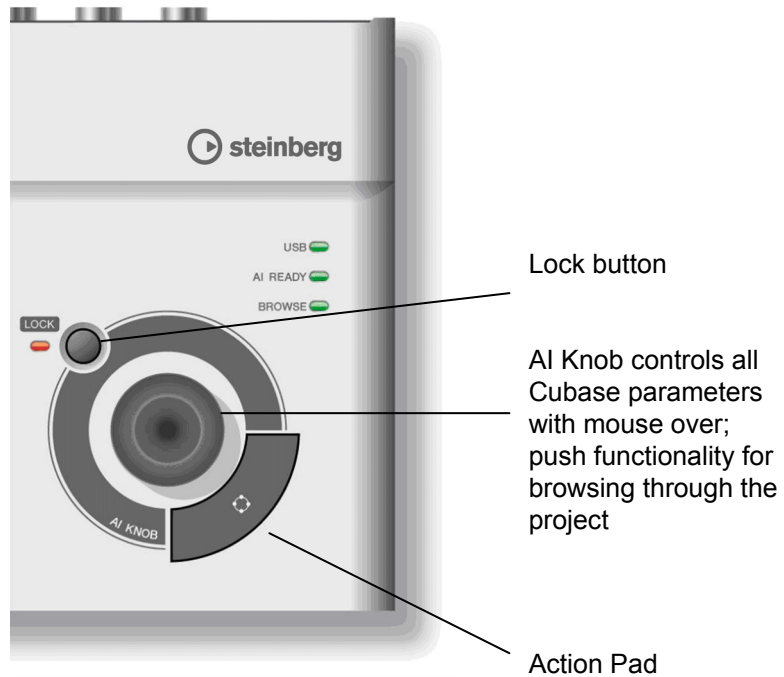

Rear panel

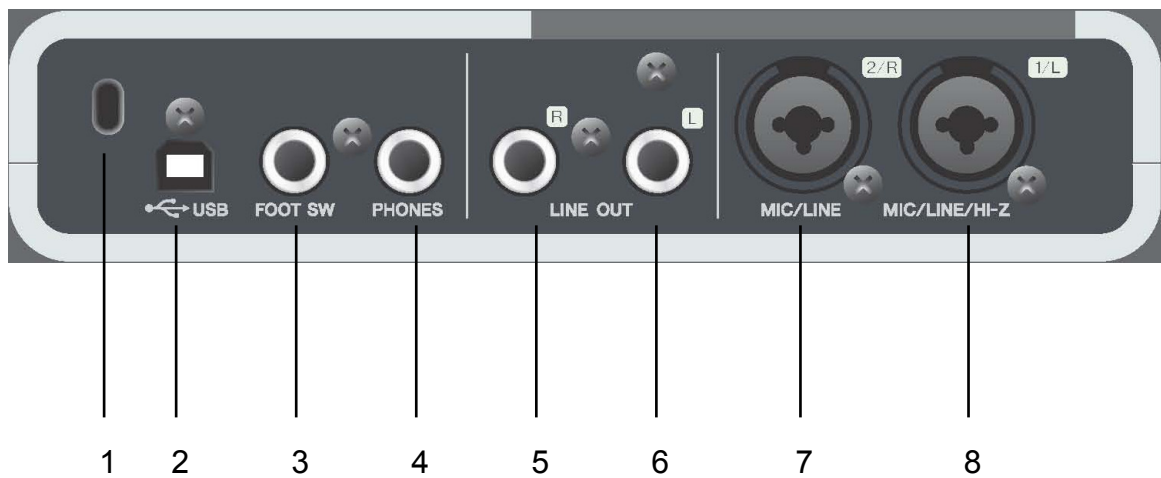

- | | |
|-------------------------|--|
| 1. Kensington Lock | 5. Line output R (TRS/TS supported) |
| 2. USB port | 5. Line output L (TRS/TS supported) |
| 3. Footswitch connector | 6. Mic/Line input 2/R XLR combo jack |
| 4. Phones output | 7. Mic/Line input 1/L XLR combo jack with HI-Z |

Front grille



Side panel



3 Technical Specifications

Electrical Characteristics

AD/DA		24 bit
Sample rate		48 kHz (max)
Gain		+60 dB (- 60 dB ~ -16 dB)
HI-Z switch	Input impedance	500 ohms
Frequency response		20 Hz – 20 kHz (-3 dB @ 1 kHz)
THD+N		0.05% (@ 1 kHz, output level: +4 dBu)
Dynamic range		96 dB (A-weighted)
Power consumption	USB (bus-powered)	5 V 500 mA 2.5 W

General Specifications

Power requirements	USB-powered
Physical dimensions (H x W x D)	45.4 mm x 190 mm x 134.5 mm
Box dimensions (H x W x D)	86 mm x 270 mm x 180 mm
Net weight	720 g
Included accessories	CI2 unit, tools for CI2 CD-ROM (Mac/PC hybrid), Cubase AI 5 DVD-ROM (Mac/PC hybrid, also contains demo project), printed CI2 operation manual (EN/DE/FR+JA), USB cable
Optional Accessories	Yamaha FC5 (footswitch), Yamaha BMS10A (mic stand adapter)